

SwingSmart DC SlowDown Kit

Package: Loctite (5 ml), Gearbox pulley, Drive belt

Tools Required:

- Phillips head screwdriver
- 7/16-inch box end wrench (or crescent wrench)
- 3/32-inch (2 mm) hex key
- Propane torch to warm Loctite and ease gearbox pulley removal

Remove SwingSmart Covers

1. Remove the top cap by unscrewing the knob.
2. Unfasten the side cover latches and remove the front cover.
3. Turn off the AC and DC power switches.
4. To remove the rear cover:
 - Use a Phillips head screwdriver to remove two screws that secure the top of the rear cover.
 - Remove the two wing nuts that secure the rear cover to the base plate.
 - Set the rear cover and all cover fasteners aside.



Due to wind load factors and heavier gate aspects, be sure to secure the SwingSmart chassis to its concrete base using all six anchor bolts. Legacy chassis requires two additional drill holes for anchor bolts.

Replace the Gearbox Pulley

5. To remove the drive belt, loosen the two motor bracket nuts using a 7/16-inch box end or crescent wrench. Slide the motor bracket to relieve belt tension.
6. Remove the drive belt.

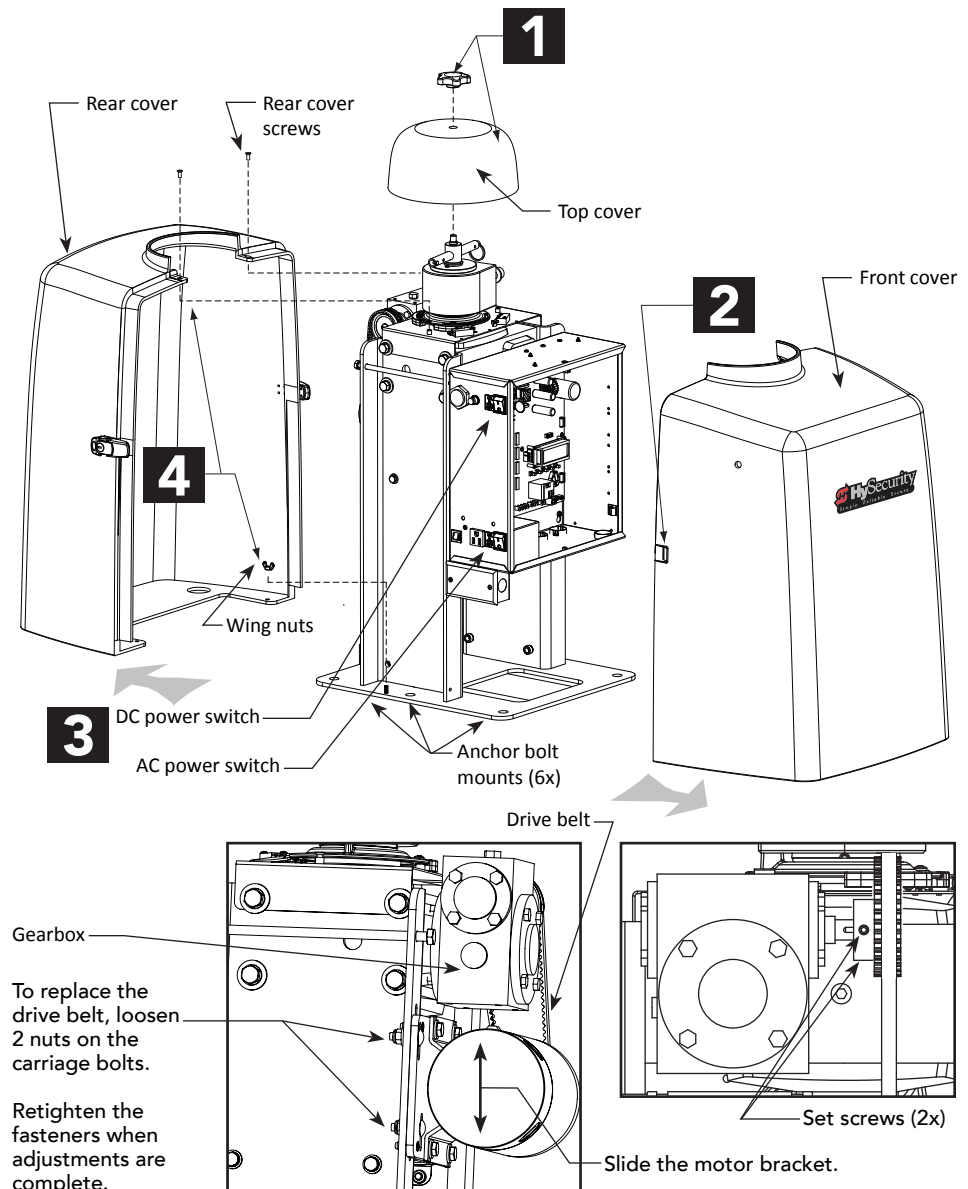

- Two set screws hold the gearbox pulley in place. Use a 3/32-inch (2 mm) hex key to remove the two set screws and slide the pulley off the gearbox shaft.

NOTE: Loctite™ is placed on the set screws at the factory. If needed, use a propane torch to warm the set screws and soften the Loctite, to ease set screw removal.

Swap Pulleys

- Take the large pulley from the Slow Down kit and remove its two set screws.
- Slide the pulley onto the gearbox shaft.
- Install the drive belt supplied with the kit. Adjust the position of the pulley so that the drive belt is centered.
- Place a drop of Loctite on each set screw as you insert them and secure the pulley to the gearbox shaft.
- Re-tension the drive belt by sliding the motor bracket, and then re-tighten the two nuts on the motor bracket's carriage bolts when the belt is positioned properly. See illustration.

NOTE: With your finger, apply light pressure to the drive belt. If it is properly tensioned, it should only move about 1/16 to 1/8-inch.

- Turn the AC and DC switches on.
- Cycle the gate operator open and close to make sure the drive belt tracks centered on the gearbox pulley. Make any necessary adjustments to ensure the drive belt tracks evenly and remains centered throughout gate travel.

NOTE: Consider your site. If needed, reconfigure the IES sensitivity menu items (SE, SS) found in the Installer Menu.

- When everything is working properly, replace the SwingSmart covers. Refer to the illustration on page 1.

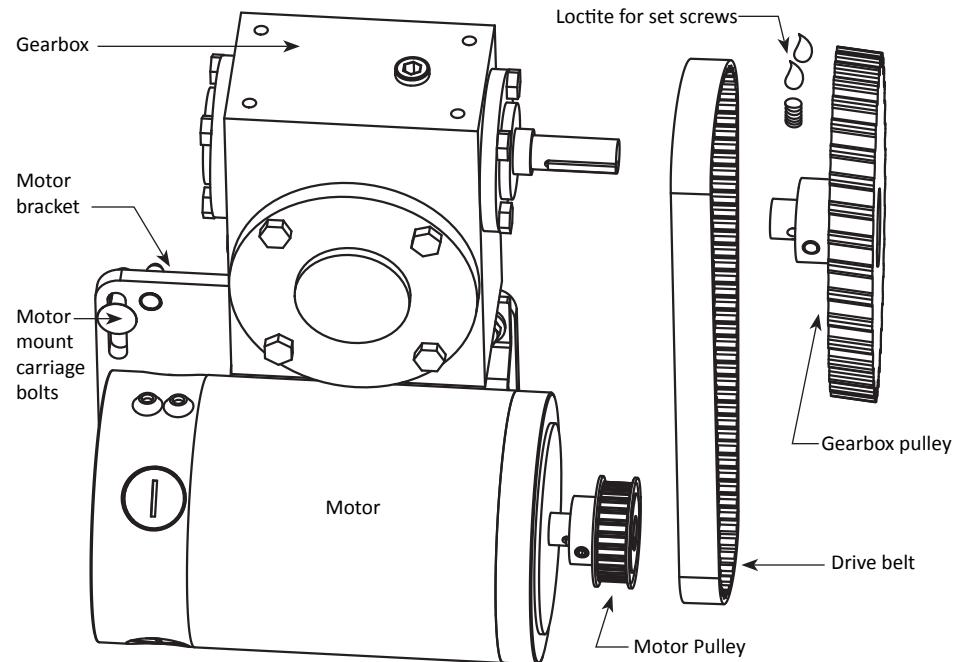

Replace and Center Drive Belt

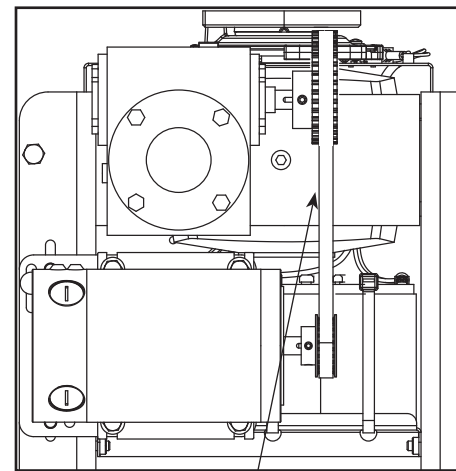

Make sure drive belt is centered on the gearbox pulley during open and close cycles.

